

UltraSlim 1RU V-Panel BASE-8 96f

UltraSlim 1RU V-Panel BASE-8 96f is designed to allow connection of Base-8 100/40G (MPO) with lower speeds 25/10G interfaces (LC DX). Fixed panel offers both installation speed and cost effectiveness against typical high density modular system. The shallow depth of UltraSlim profile is unique making it suitable for low depth cabinet or racking systems. V shape profiled front together with cable management accessories facilitates managing front and rear cabling. Low loss MPO and LC Premium terminations are offered featuring significantly improved low insertion losses for demanding low power budget, high speed networks.

Features

- Dedicated Base-8 configuration for 96 x Fibres
- UltraSlim profile suitable for low depth racks or cabinet
- Optimised front space for extraction free LC port finger access
- Improved Installation time and cost effectiveness of single panel
- V shape to improve patching management
- Optimised Performance - Low loss MPO, discrete premium connectors and OM4 fibre assures low insertion losses and power penalties in tight power budget, high speed network environments
- Reliability - 100% Tested - Combination of high quality components and manufacturing quality control guarantees product to the highest standards
- Rapid Deployment - Factory pre-populated panel saves installation time - 1 x click to connect 12 fibres using MPO interface

Applications

- Data communication applications
- Data Centre infrastructure
- Storage Area Network - Fibre Channel
- 40 and 100 Gbps Protocols compatible

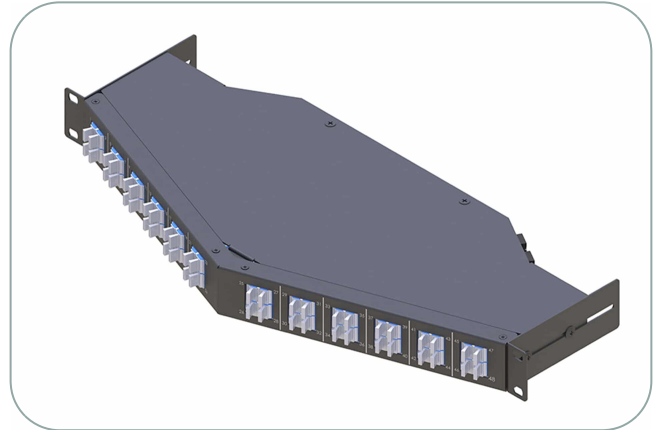

Specifications

ELEMENT	CHARACTERISTIC
Fibre	SM G.657A1, MM OM4
Fibre Count	96

ELEMENT	CHARACTERISTIC
MPO Adapters	IEC 61754 & EIA/TIA 604-5 Body Colour: Black
LC Adapter	LC Quad Body Colour:Aqua (MM)(OM4), Blue (SM/UPC), Green (SM/APC)
Terminations	12xMPO Low Loss Premium (12 Fibre Ferrule) & 96xLC Low Loss Premium
Storage Temperature	-20 ~ +60°C
Installation Temperature	-20 ~ +60°C
Operating Temperature	-20 ~ +60°C
Dimensions (W x D x H)	464 x 193 x 44mm
Dimensions (Packaged) (W x D x H)	545 x 260 x 70mm
Weight	2kg
Weight (Packaged)	2.2kg

Connector Performance

CONNECTOR MATING	IL AVERAGE	IL MAX	RETURN LOSS
MPO Premium (MM)	0.10 dB	0.35 dB	N/A
NA	NA	NA	N/A
MPO Premium (SM)	0.10 dB	0.35 dB	>60 dB
NA	NA	NA	NA

OPTICAL PERFORMANCE	MM PREMIUM	NA	SM PREMIUM	NA	CONFORMANCE
IL Max/Master (Acceptance)	0.15 dB	NA	0.15 dB	NA	IEC 61300-3-4
Ave/Master	0.08 dB	NA	0.12 dB	NA	IEC 61300-3-4
Ave/Random	0.10 dB	NA	0.12 dB	NA	IEC 61300-3-34
RL(Min Acceptance)	NA	NA	55/65 dB*	NA	IEC 61300-3-6

*UPC/APC

Ordering Information

PART NUMBER	DESCRIPTION
A4U596BPAV-05DP	AFL Ultraslim Panel 1RU Angled Front BK Premium LC - MPO M MM OM4 96F BASE8
A7U596BPAV-05DP	AFL Ultraslim Panel 1RU Angled Front BK Premium LC - MPO M SM G.657A1 96F BASE8
A7U596BPBV-05DP	AFL Ultraslim Panel 1RU Angled Front BK Premium LCA - MPO M SM G.657A1 96F BASE8